

# HM3 Automatic Alcohol Dispenser

## Warning

- Please read the enclosed instruction manual carefully before using.
- Do NOT add any liquid other than "HM Plus Hand Sanitizer" or alcohol to prevent damaging the machine. Damage caused by adding liquids other than "HM Plus Hand Sanitizer" and alcohol is not covered by warranty.
- ONLY use alkaline batteries (AA batteries) to maintain normal function of the machine.
- The product is an Automatic Alcohol Dispenser. Do not use for other purposes.
- Keep the product away from heat, sparks, and fire. It should be stored in a cool and well-ventilated place.
- Do not put any hazardous substances into the product, such as acid, alkaline, poisonous liquids, etc.
- Keep face away from the spray nozzle to prevent triggering the sensor and injuring the eyes.

## HM Plus Hand Sanitizer Usage Warning

- This product contains alcohol. The product MUST be kept away from heat, sparks, and flames.
- The hand sanitizer is for external use only.
- In case of eye contact, immediately flush eyes with water.
- Keep the hand sanitizer out of childrens' reach.
- Please store the hand sanitizer and machine at room temperature between 5°C and 40°C to prevent the alcohol from evaporating and reducing the effectiveness of the product.
- Please do not add anything to the hand sanitizer to avoid clogging the nozzle.

## Machine Attention

- Do NOT add any liquid other than "HM Plus Hand Sanitizer" or alcohol into the Automatic Alcohol Dispenser to prevent clogging or corroding the nozzle.
- When adding the alcohol, do not exceed the triangle mark to prevent overflow or machine malfunction.
- When installing or moving the machine, keep the machine upright; tilting or horizontal placement of the machine can cause leakage or machine malfunction.
- Use alkaline batteries (AA batteries); be sure to confirm the corresponding positive(+) and negative(-) pole position when installing the batteries.
- Do not use batteries of two different brands or use new and old batteries at the same time.
- If the product won't be used for a long time, turn the machine OFF and take out the batteries. Please also empty the container and let it dry thoroughly.
- The machine is water resistant but NOT WATERPROOF. Do not wash or submerge the machine and do not place it in the rain.
- The machine uses an infrared sensor. Strong lights such as sunlight may interfere with its function.
- When electrical outlet is used to supply power to the product, please take out the batteries to prevent leakage that can possibly damage the machine.

## Before Using

- [1] Insert the machine into the drip tray.

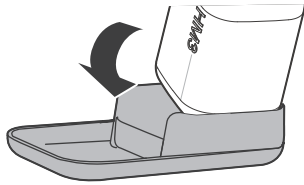

- [2] Remove the battery lid, insert four AA batteries into the compartment properly and replace the battery lid. The product is pre-set to OFF mode to prevent the product from operating before battery installation is finished.

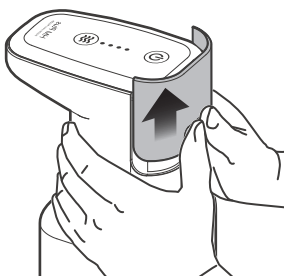

- [3] Open the container by twisting the lid half circle counter clockwise. Pull the silicone pipe out and place the lid on a clean surface to avoid dust contamination inside the pipe.

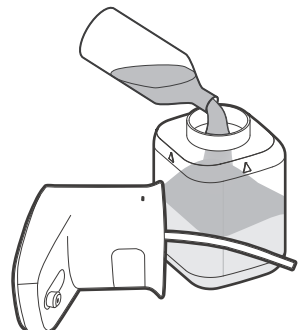
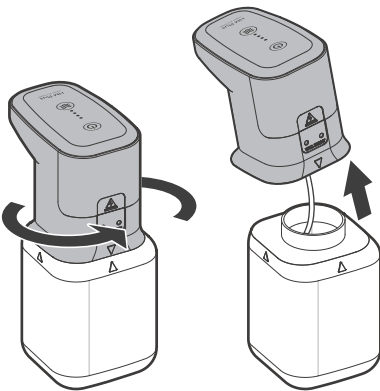

- [4] Pour alcohol into the bottle until the maximum level mark on the top back of the container, and then twist the lid to tighten it back to its original position. ※ Please keep the silicone pipe clean and dust-free before screwing the lid back onto the container

## Diagram & Function

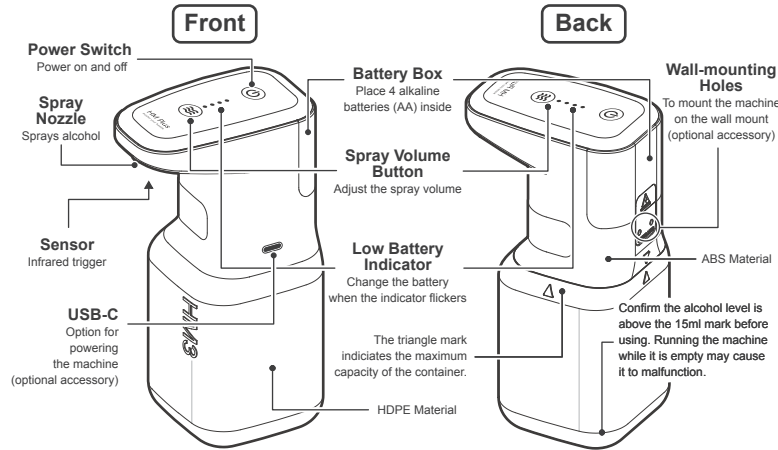

## Setting

### Spray Volume Settings:

While the machine on, press the spray volume button to adjust the spray volume.

### Standby Mode:

When the machine is left unused for more than 60 seconds, all LED lights will turn off to save power.

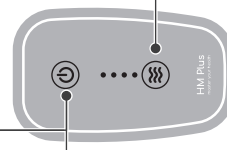

### Turning On:

Press the ON/OFF button for 2 seconds. The LED indicator light will light up from bottom to top and display the current spray volume setting. The lights will go out after 60 seconds.

### Turning Off:

When the machine is on, press the ON/OFF button for 2 seconds to turn off. The LED indicator will flash 3 times before the machine is turned off.

## Specification

Dimensions	
Large:100 x 130 x 238 mm Small:100 x 130 x 198 mm	
Weight	400 g including the container and batteries
Spray	Four adjusting segments(± 0.2 cc) 1st-segment: 0.5 cc 2nd-segment: 0.7 cc (Default) 3rd-segment: 1.0 cc 4th-segment: 1.5 cc
Pump	DC Pump
Power supply	AA-size alkaline batteries x 4
USB-C Specification	5V1A

## How to Use?



- [1] Place your palms under the spray nozzle and it will automatically spray a fixed amount of alcohol. The LED indicator will simultaneously display the spray volume level.

- [2] Use your palms to catch the alcohol until it automatically stops spraying.

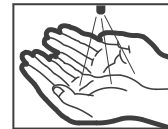

- [3] Spread the alcohol thoroughly over your palms, fingers, nails, etc.; rub both hands together gently and let dry.

## Machine Maintenance

- When the sensor is covered with dust or fingerprints, the sensor function may be affected. To maintain the machine's normal function, gently clean the sensor with a cotton swab.
- To clean the exterior of the machine, wipe with a soft cloth, or wipe with a damp cloth and dry with another cloth.
- The machine is not waterproof, do not wipe with a drenched cloth. Do not wash directly under running water.
- Do not clean the machine with metal brushes, nylon brushes, chemical wipes, bleach, etc.

## Trouble Shooting

The pump is running but nothing comes out when hands are placed underneath the nozzle.	Please check if the alcohol volume is lower than the "low level" mark on the container; if it is, please refill the machine with alcohol for it to operate normally.
The pump is not running and no spray comes out when hands are placed underneath the nozzle.	Please check if the power is on. Please check if the batteries are correctly installed. Please check if the battery indicator is flashing. If yes, replace with new batteries.
The alcohol comes out in excessive volume.	Check if the machine is placed on a shiny, reflective surface. If so, put a cloth underneath the machine to block light reflection.
The machine continues spraying when not using it.	